

# F21

## Fingerprint time attendance and access control terminal



F21 is the first time attendance and access control terminal applying the most advanced Z-ID technology. It not only possesses outstandingly high identification rate towards dry, wet and rough finger, but also provides the utmost security by its live finger detecting capability, as well as photo taking function which enables attendance photo and Photo ID (optional).

In addition, with the brand new ZMM220 hardware platform, its clock rate can attain 1.2GHz. Such speedy hardware platform and fingerprint algorithm greatly enhance the speed of fingerprint verification.

### Features

- 2.4-inch TFT color screen
- Z-ID fingerprint reader with living object detecting function
- Multiple Verification Modes: Multi-verification methods (card is optional) providing user various choices
- Full Access Control Features: Anti-passback, access control interface for 3rd party electric lock, door sensor, exit button, alarm and doorbell
- Camera Function: record photo, photo ID (optional)
- Built-in auxiliary input with enhanced flexibility to link with wired detector or emergency switch

# Specifications

|                          |  |
|--------------------------|--|
| Display                  | 2.4-inch TFT LCD Color Screen  |
| Fingerprint Capacity     | 3000   |
| Card Capacity            | 5000 (Optional) ID or IC Card  |
| Transaction Capacity     | 100,000  |
| Sensor                   | Z-ID Sensor  |
| Algorithm Version        | ZKFinger V10.0   |
| Communication            | RS232/ 485*, TCP / IP, USB-host  |
| Access Control Interface | 3rd Party Electric Lock, Door Sensor, Exit Button, Alarm, Doorbell             |
| Wiegand Signal           | Input, Output, SRB   |
| Aux. Input               | 1ea for linkage function   |
| Functions                | DST, Automatic Status Switch, Anti-passback, Scheduled-Bell, Printer(Optional) |
| Power Supply             | 12V DC, 3A   |
| Operating Temperature    | 0 °C- 45 °C  |
| Operating Humidity       | 20%-80%  |
| SDK and software         | Standalone SDK, ZKbio CVAccess   |

\* Note: RS232 is for external printer and RS485 is for RS485 readers.

## Optional Accessories

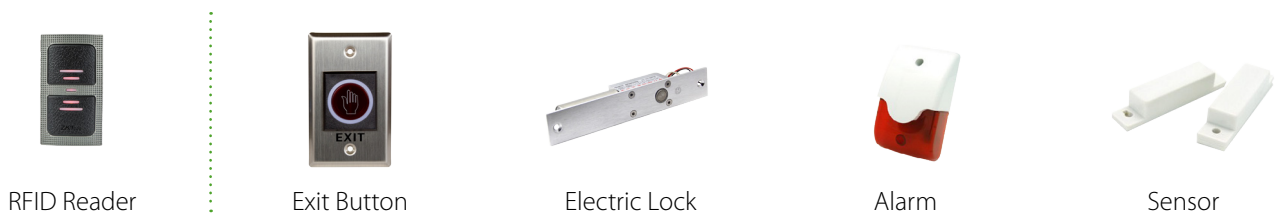

## Configuration

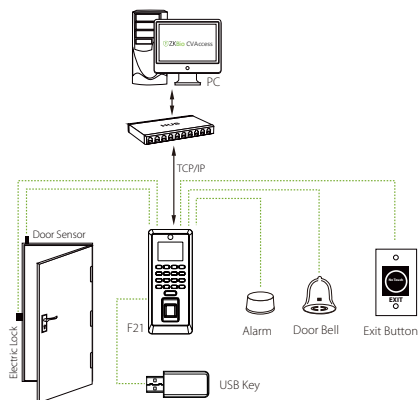

## Dimensions (mm)

